

2ND FLOOR PLAN
SCALE: 1/8" = 1'-0"

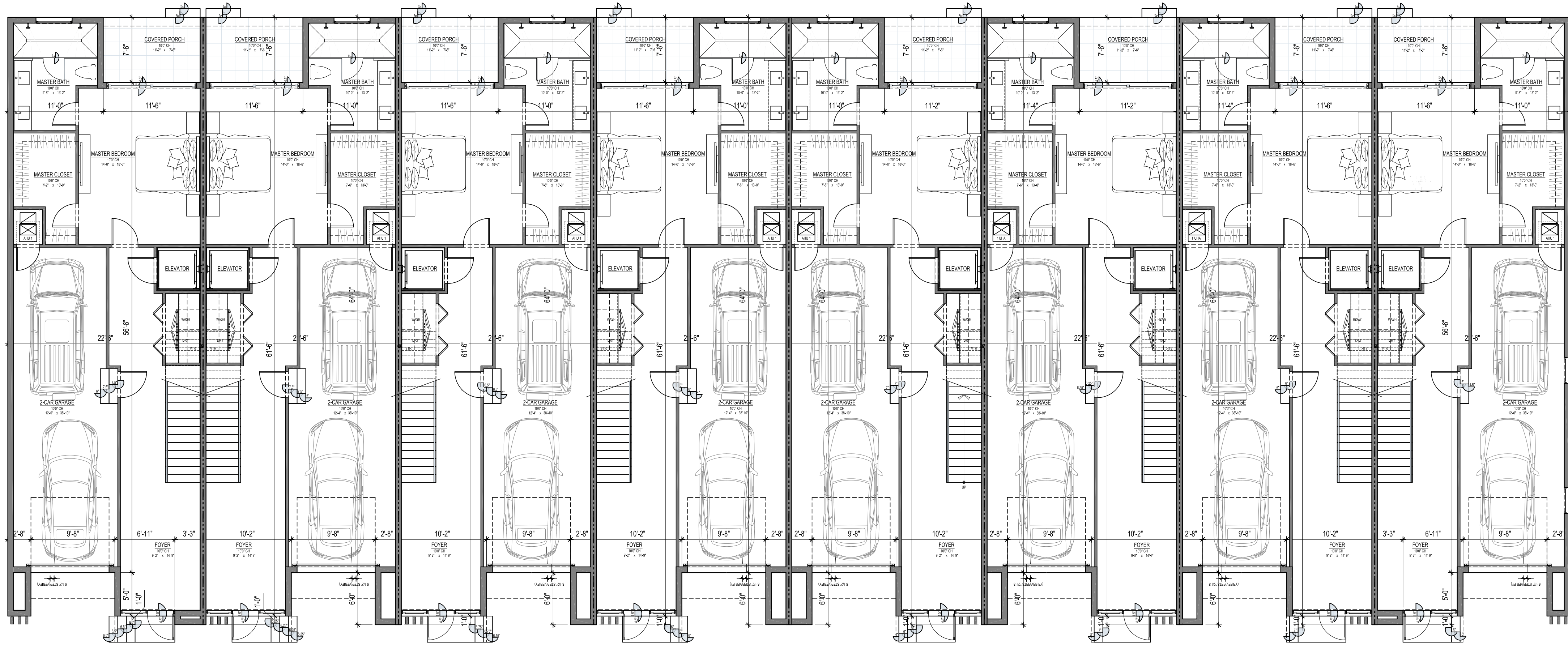

1st FLOOR PLAN
SCALE: 1/8" = 1'-0"

INTERIOR UNIT TYPE - AREA CALCULATION	
1ST FLOOR A/C	950 SQ. FT.
2ND FLOOR A/C	1323 SQ. FT.
3RD FLOOR A/C	962 SQ. FT.
TOTAL A/C	3235 SQ. FT.
2-CAR GARAGE	470 SQ. FT.
COVERED ENTRY	21 SQ. FT.
2ND FLOOR - COVERED FRONT BALCONY	92 SQ. FT.
2ND FLOOR - COVERED REAR BALCONY	75 SQ. FT.
3RD FLOOR - COVERED FRONT BALCONY	92 SQ. FT.
TOTAL COVERED AREA	3986 SQ. FT.
3RD FLOOR - REAR BALCONY	236 SQ. FT.
TOTAL	4222 SQ. FT.

END UNIT TYPE - AREA CALCULATION	
1ST FLOOR A/C	953 SQ. FT.
2ND FLOOR A/C	1320 SQ. FT.
3RD FLOOR A/C	960 SQ. FT.
TOTAL A/C	3233 SQ. FT.
2-CAR GARAGE	468 SQ. FT.
COVERED ENTRY	21 SQ. FT.
2ND FLOOR - COVERED FRONT BALCONY	96 SQ. FT.
2ND FLOOR - COVERED REAR BALCONY	75 SQ. FT.
3RD FLOOR - COVERED FRONT BALCONY	159 SQ. FT.
TOTAL COVERED AREA	4051 SQ. FT.
3RD FLOOR - REAR BALCONY	236 SQ. FT.
TOTAL	4287 SQ. FT.



#25009

architecture + energy of intelligence

INTELAE

office: 561.672.7124 website: intelae.com
1615 south federal highway + suite 206
boca raton + florida + 33432

S.E. 5TH STREET TOWNHOMES
FOR: MARSAL MAINTENANCE CORP.
3305 S.E. 5TH STREET
POMPANO BEACH, FL 33062

REVISIONS:
12-1-2025
3-2-2026
4-28-2026
DRC ZONING REVIEW
DRC ZONING RESUBMITTAL
DRC ZONING RESUBMITTAL

architect

DATE: 9-2-2025
DRAWN / CHECKED: LAU / LR
PERMIT: CONSTRUCTION

STATE OF FLORIDA
REGISTERED ARCHITECT
RONALD J. RIGBY
AR13630
©2025 - P&H

A1.0